

CAE260S

Model number:

103678

Dimensions: 60" x 35" x 81"

Installation: Alcove

Material: Acrylic



Standard Features:

- Right- or left-hand drain
- Large shelving
- 17 in. skirt height
- 2 3/4 in. drain clearance

Product characteristics:

- Made in North America
- Cast Acrylic
- Built-in shelves

Warranty:

25 Years

Standard colors:



White (001)

Certifications

MAAX products adhere to one or more of the following certifications:



CAE260S

Model number:

103678

Dimensions: 60" x 35" x 81"

Installation: Alcove

Material: Acrylic

STANDARD

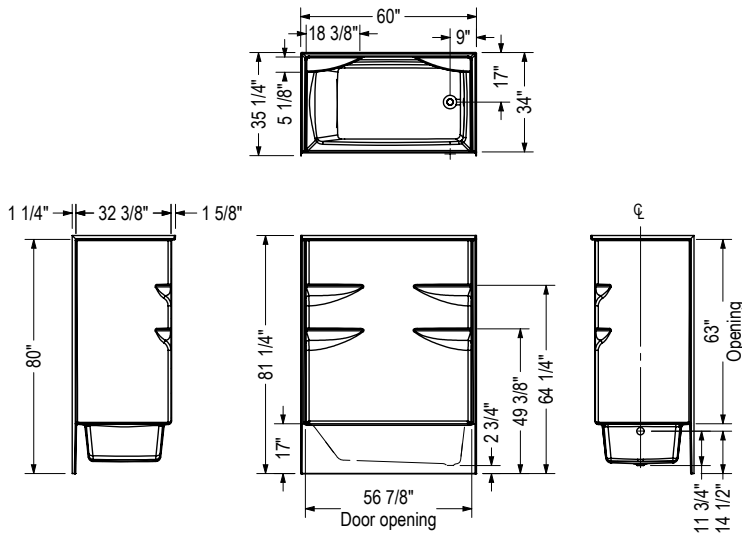

Dimensions:

60 x 35 1/4 x 81 1/4 in.
(1524 x 895.35 x 2063.75 mm)

Water capacity:

43 gallons - 162.773 liters

Weight:

161 lbs - 73 kg

Bathing well:

44 5/8 X 24 3/4 in.
(1133.475 X 628.65 mm)

Deep sump height:

9 5/8 in. - 244.475 mm

Drain location:

Left

Right

All dimensions are approximate. Structure measurements must be verified against the unit to ensure proper fit.

Project:

Contractor:

Representative:

Date:

Tel:

Notes: