

**A18**  
**Wall Mounted Overhead Shower Arm**  
**Specification Submittal**

Model Number	Specification
<input type="checkbox"/> <b>A18</b> <i>Wall Mounted Overhead Shower Arm</i>	Wall mounted overhead shower arm is 18" in length. Includes shower arm flange. Components constructed from brass. Shower arm is plated in standard polished chrome finish.
Modifications	Compliance
<input type="checkbox"/> <b>-STN</b> <i>Satin nickel finish</i>	N/A
<b>Note:</b> Append appropriate -suffix to model number.	Warranty
	<b>Limited Lifetime</b> - to the original end purchaser in consumer installations. <b>5 Years</b> - for commercial installations.  Refer to <a href="http://www.symmons.com/warranty">www.symmons.com/warranty</a> for complete warranty information.

**Dimensions**

Measurements	
A	Ø 2 1/4", 57 mm
B	2 7/16", 62 mm
C	1/2"-14 NPT
D	18", 457 mm
E	1/2"-14 NPT

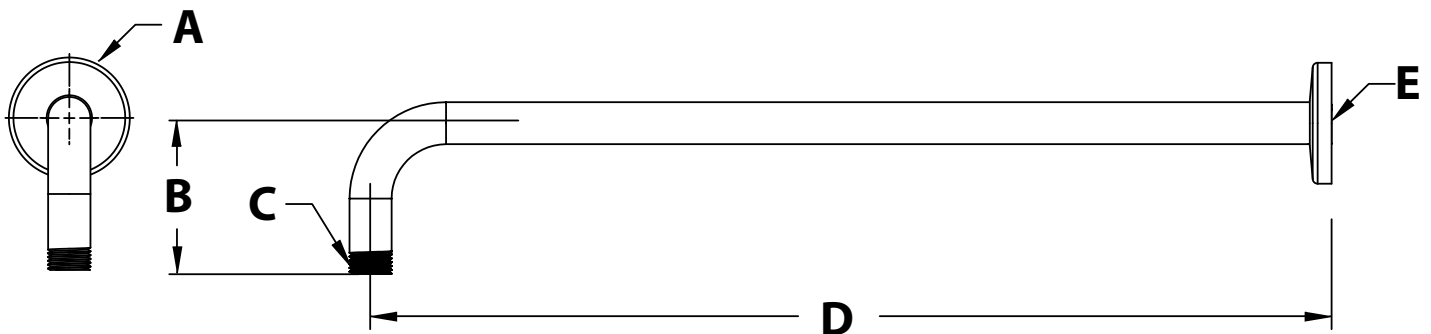

**Note:**  
Dimensions are subject to change without notice.